

# Data Sheet

## Noise-Lock®+ W-350 Acoustic Window

### IAC Acoustics

IAC House, Moorside Road, Winchester  
Hampshire, SO23 7US, United Kingdom  
T: +44 (0) 1962 873 000  
[www.iac-acoustics.com](http://www.iac-acoustics.com)



### Overview

- Certified performance rating
- Manufactured to standard and custom sizes
- Rugged steel construction
- Finished in polyester powder coating as standard

#### Standard Features



Acoustic  
Rated

#### Optional Extras



Fire  
Rated



Bullet  
Resistance



Angled  
Panes

### Acoustic Rating

STC-64(dB) to achieve minimum NIC 62 once installed (subject to flanking).

Rw [C; Ctr] 64 [-3; -8] dB to achieve minimum R'w62dB once installed (subject to flanking).

Calculated performance using standard 400mm wall thickness arrangement as follows:

| Frequency          | 63 | 125 | 250 | 500 | 1k | 2k | 4k | 8k | Hz |
|--------------------|----|-----|-----|-----|----|----|----|----|----|
| Noise-Lock®+ W-350 | 41 | 49  | 59  | 69  | 75 | 80 | 91 | -  | dB |

## Overview

IAC Acoustics produces an engineered system — custom-designed in-house to suit the required opening of any given project. Utilising precision laser cutting and state-of-the-art fabrication, all Noise-Lock® windows are simple to assemble on site by our network of highly experienced installation crews.

Noise-Lock® windows are laboratory-tested for performance in both IAC's own R&D facilities and independent laboratories, further supported by installed site testing. IAC Acoustics is renowned for quality, durability and guarantees in-field performance.

## Design Features

IAC Acoustics Noise-Lock® windows are available with a number of standard and custom design options. Please consult IAC Acoustics for availability of both standard and bespoke features such as angled panes, bullet resistant glass and EN 16 34-1 (EI) fire rated frames in various specifications. All IAC Noise-Lock® windows are built to order and site assembled using laminated safety glass as standard.

- ① 20.8mm laminated safety glass
- ② 16.8mm laminated safety glass
- ③ Acoustic foam
- ④ Host wall
- ⑤ Neoprene acoustic seal
- ⑥ Painted steel capping frame
- ⑦ Acoustic foam retainer

The relationship between the clear view and structural openings for both width and height is the same for all sizes of Noise-Lock®+ W-350 windows. Measurements to consider can be seen in the table below.

|                    | width    | height   |
|--------------------|----------|----------|
| Structural Opening | X        | Y        |
| Clear View         | X - 66mm | Y - 66mm |

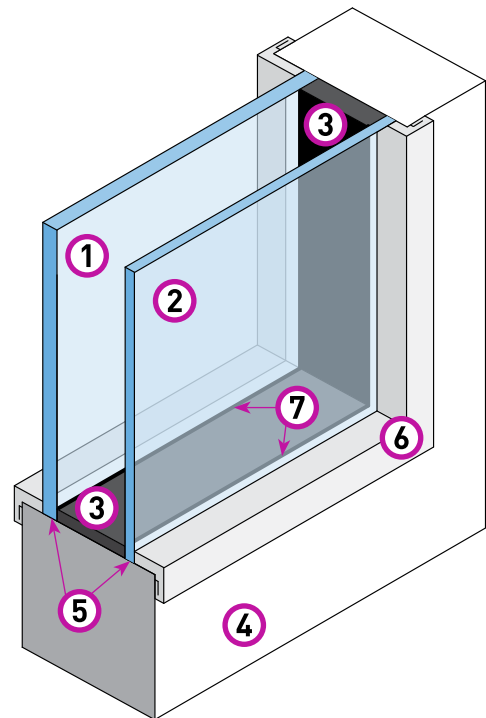

## Performance Features

- Acoustically de-coupled high performance steel acoustic window
- Architecturally aesthetic steel capping frame with secret fixings as standard
- Custom-built to order with various options for:
  - angled panes
  - fire resistance
  - bullet resistance

## IAC Acoustics

IAC House  
Moorside Road  
Winchester, SO23 7US

T: +44 (0) 1962 873 000  
F: +44 (0) 1962 873 111  
E: winchester@iac-acoustics.com

[www.iac-acoustics.com](http://www.iac-acoustics.com)